

# VS TAL<sup>®</sup> Larder 470

**VAUTH  
SAGEL**

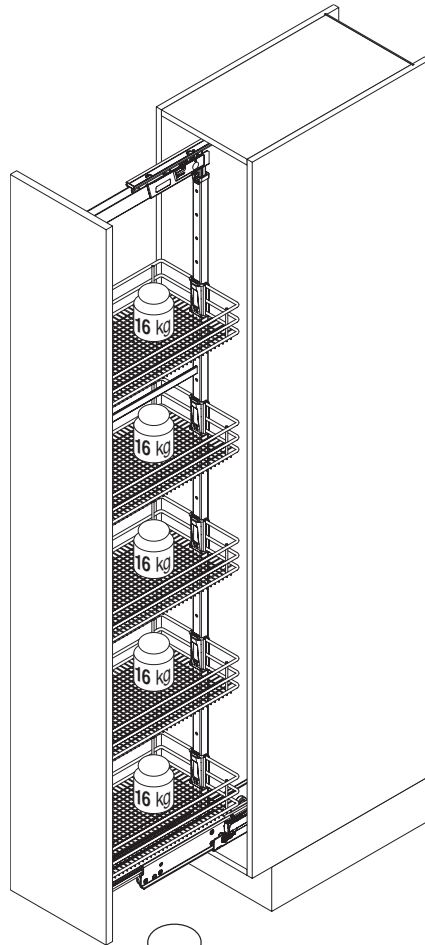

$\Sigma$  = max. 80 kg

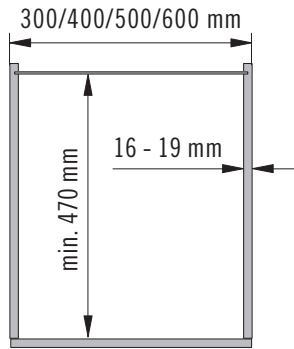
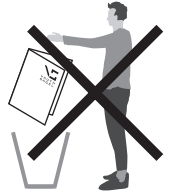
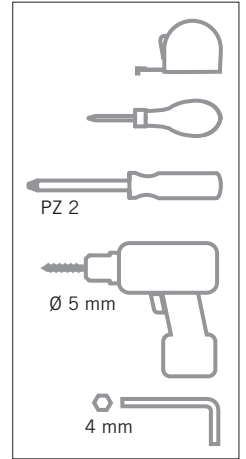

**VAUTH  
SAGEL**  
QUALITY  
MADE IN GERMANY

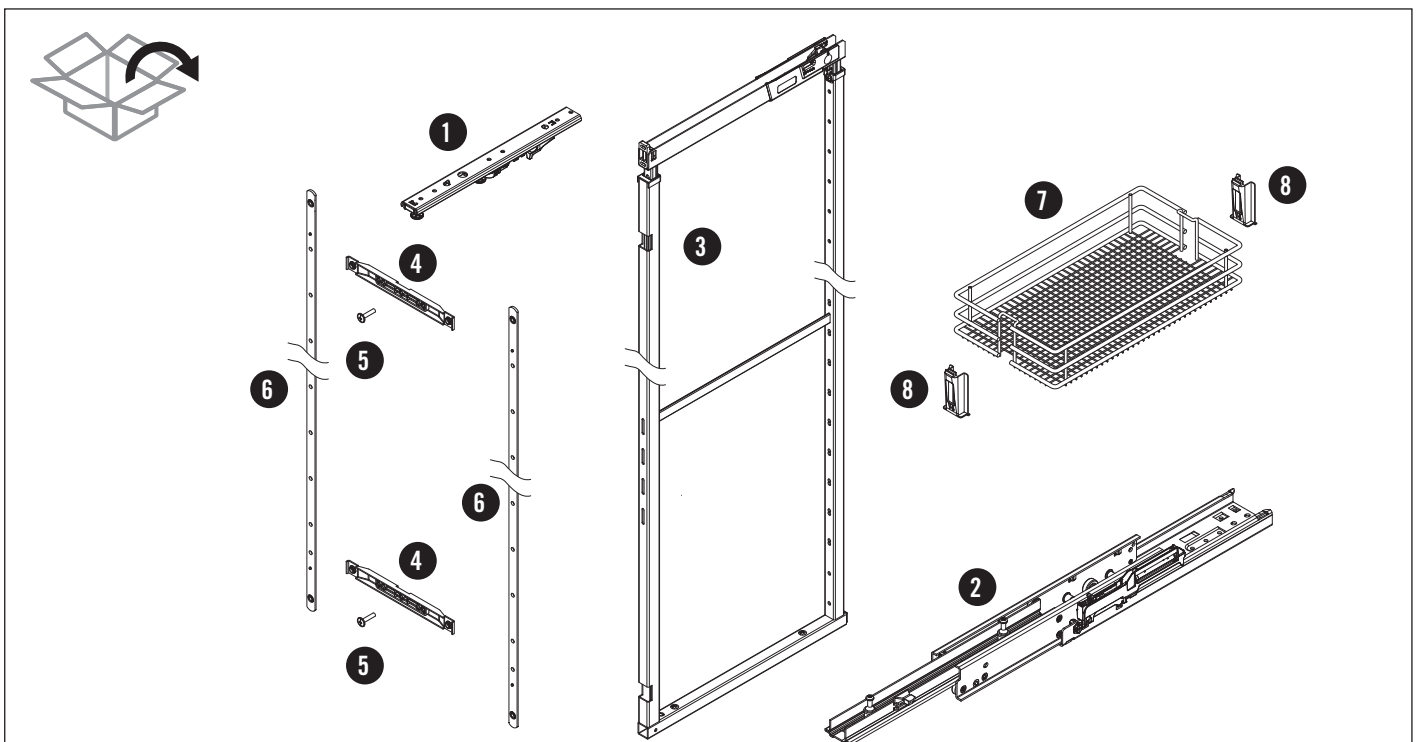

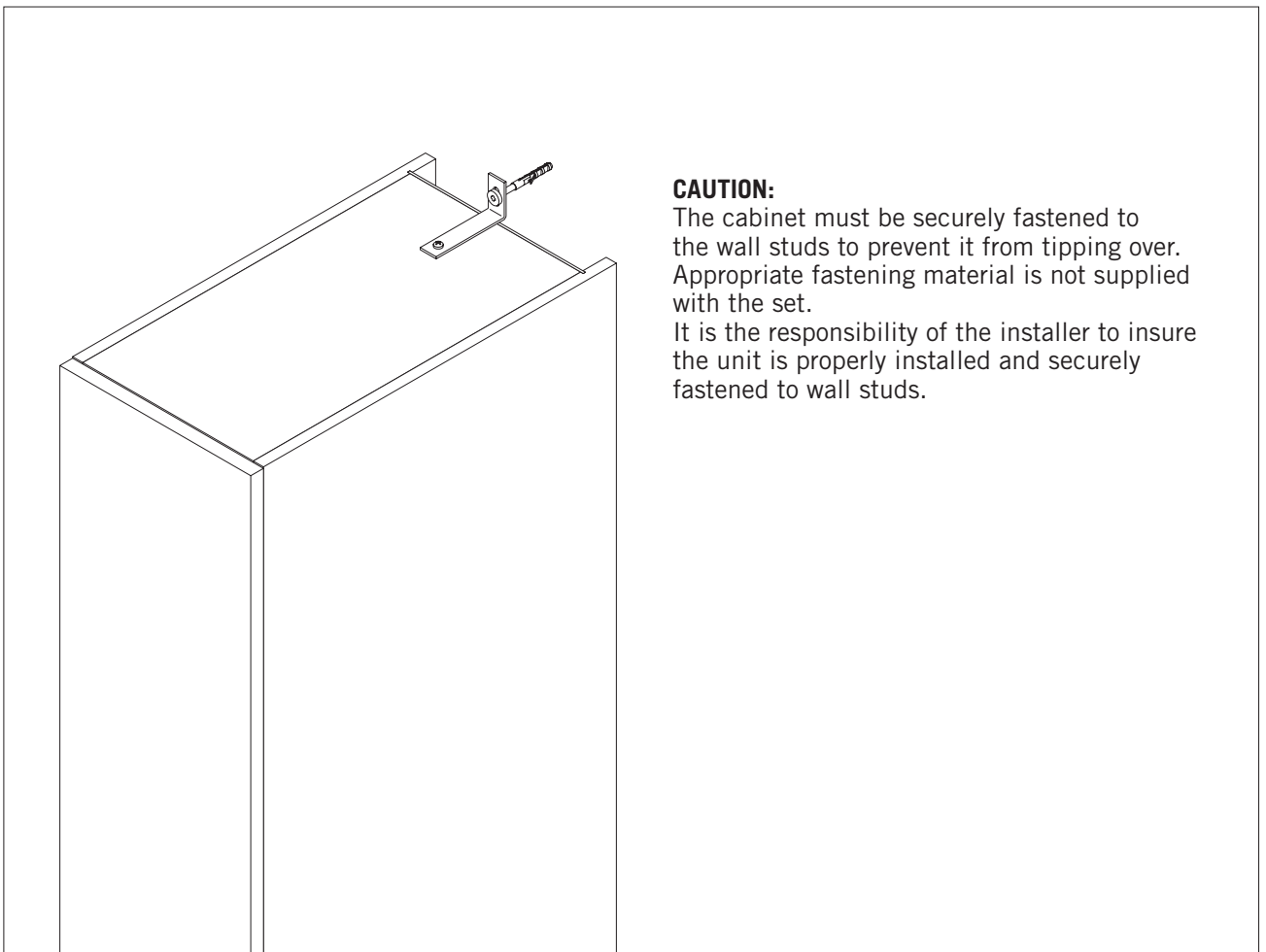
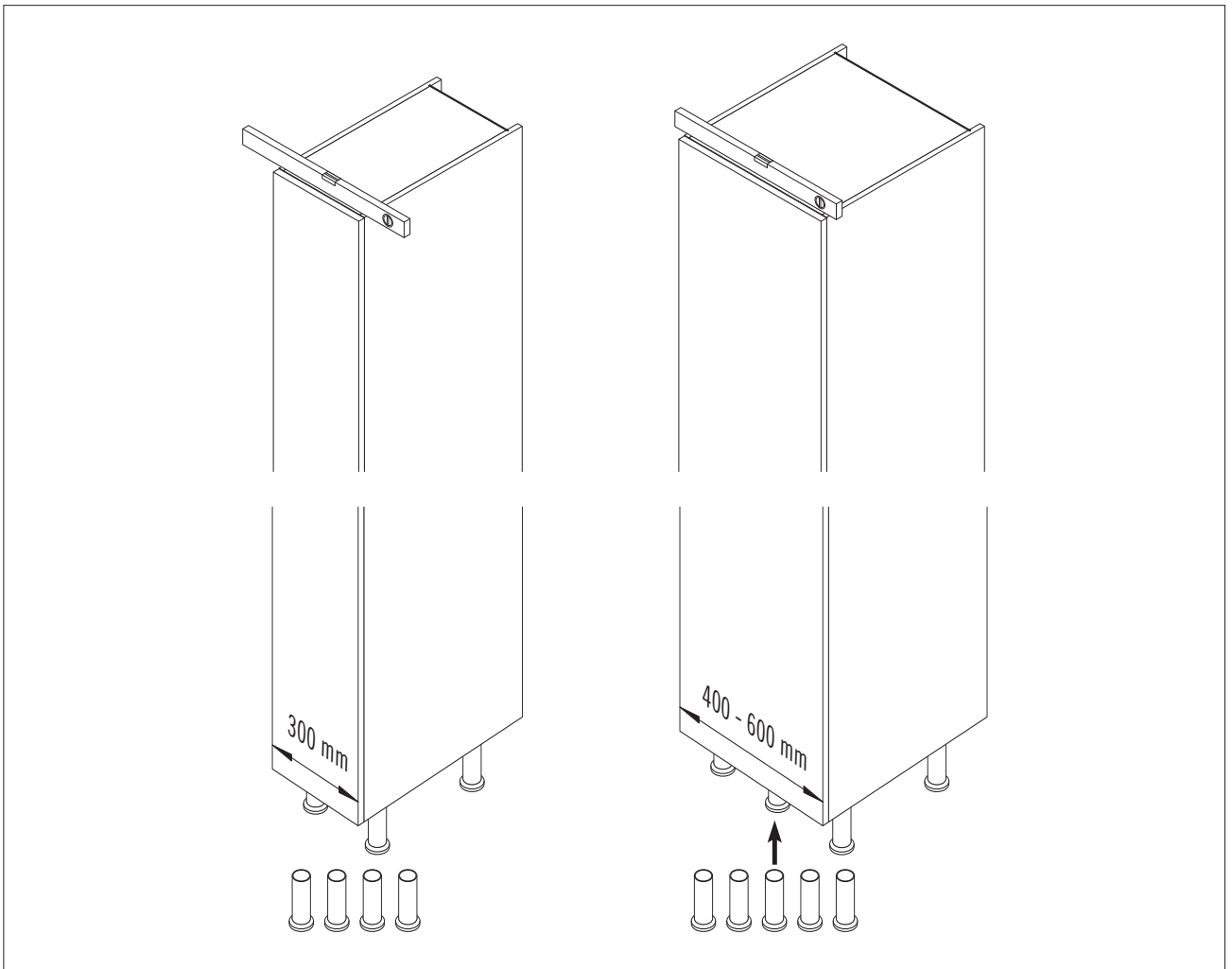

**CAUTION:**

The cabinet must be securely fastened to the wall studs to prevent it from tipping over. Appropriate fastening material is not supplied with the set.

It is the responsibility of the installer to insure the unit is properly installed and securely fastened to wall studs.

1

Please install top runner first.

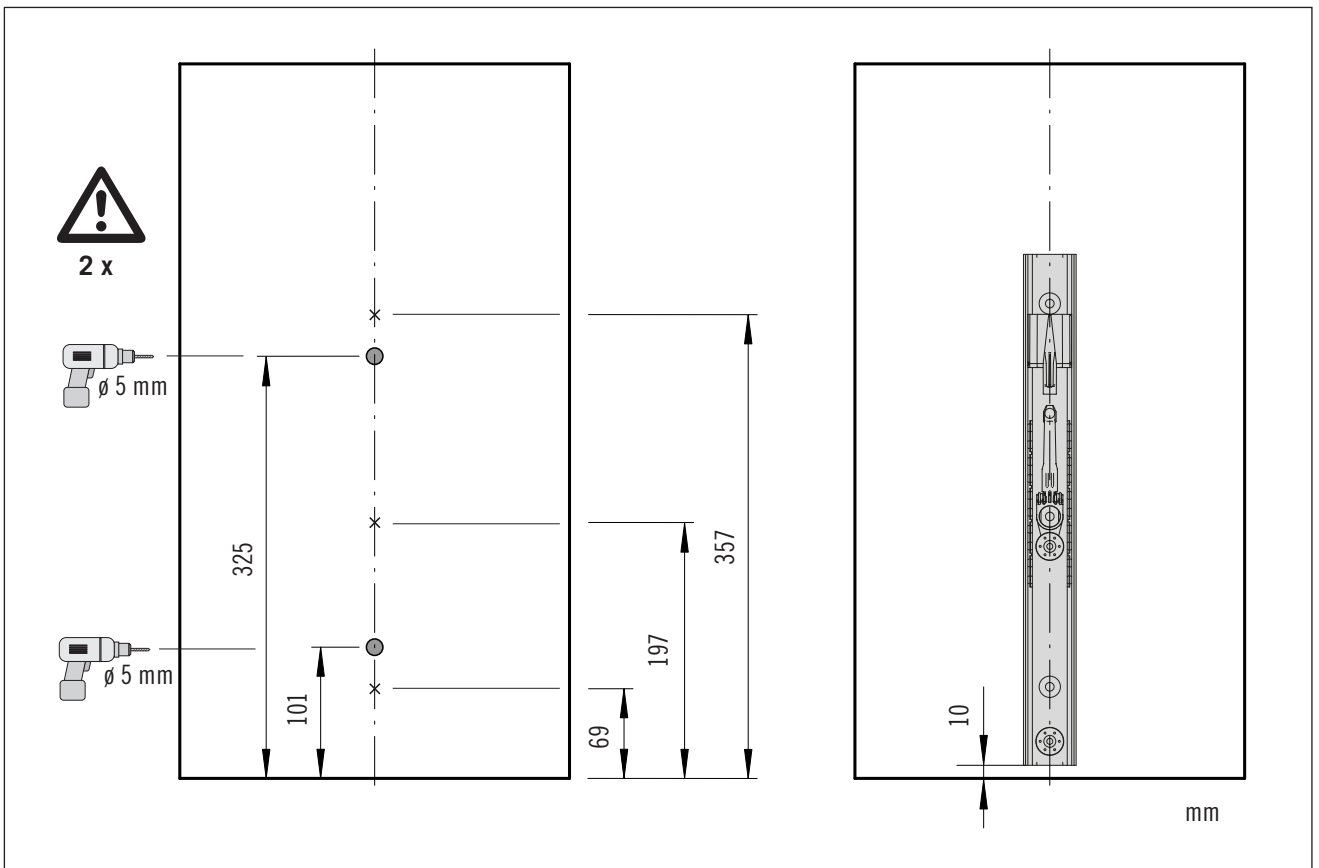
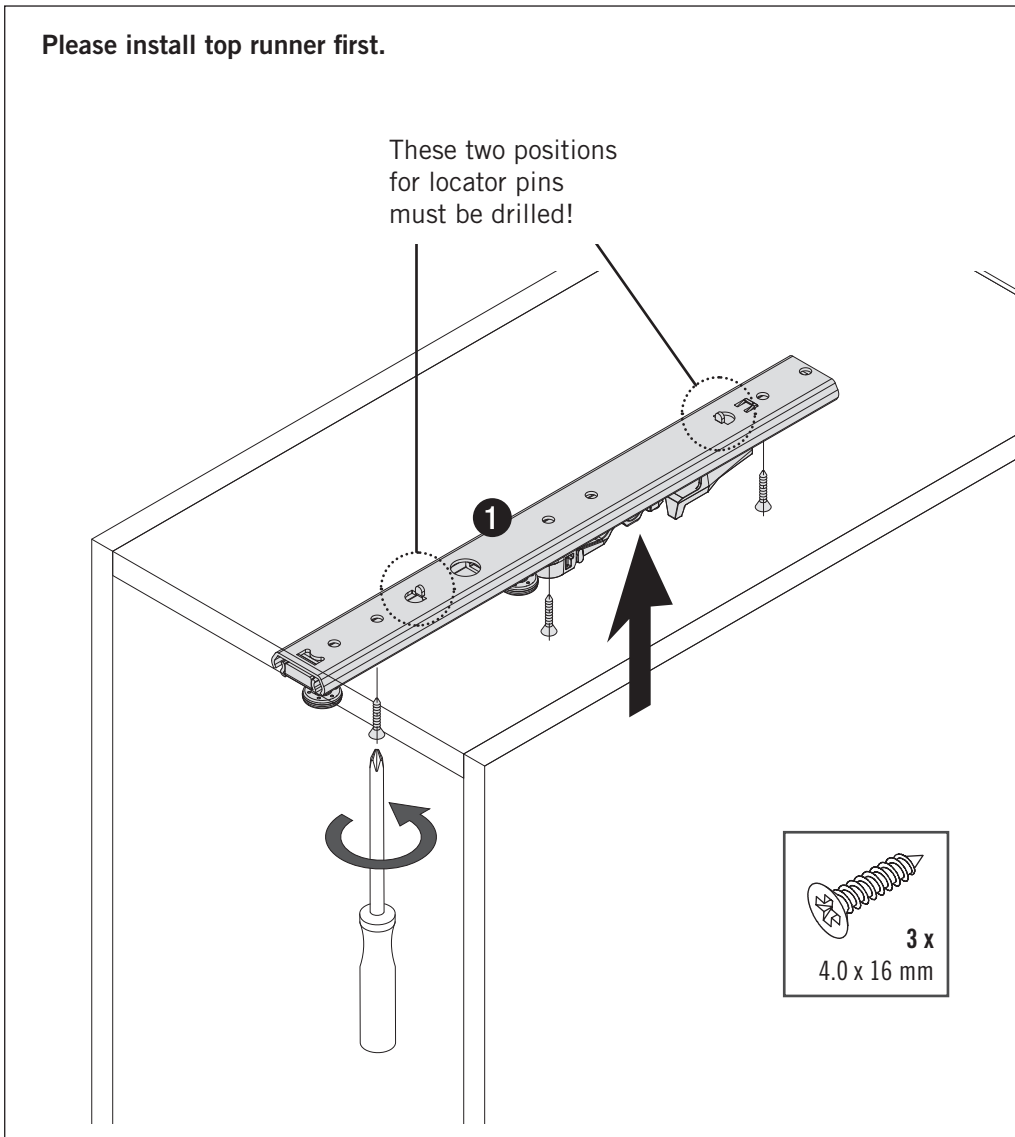

2



(PZ 2)

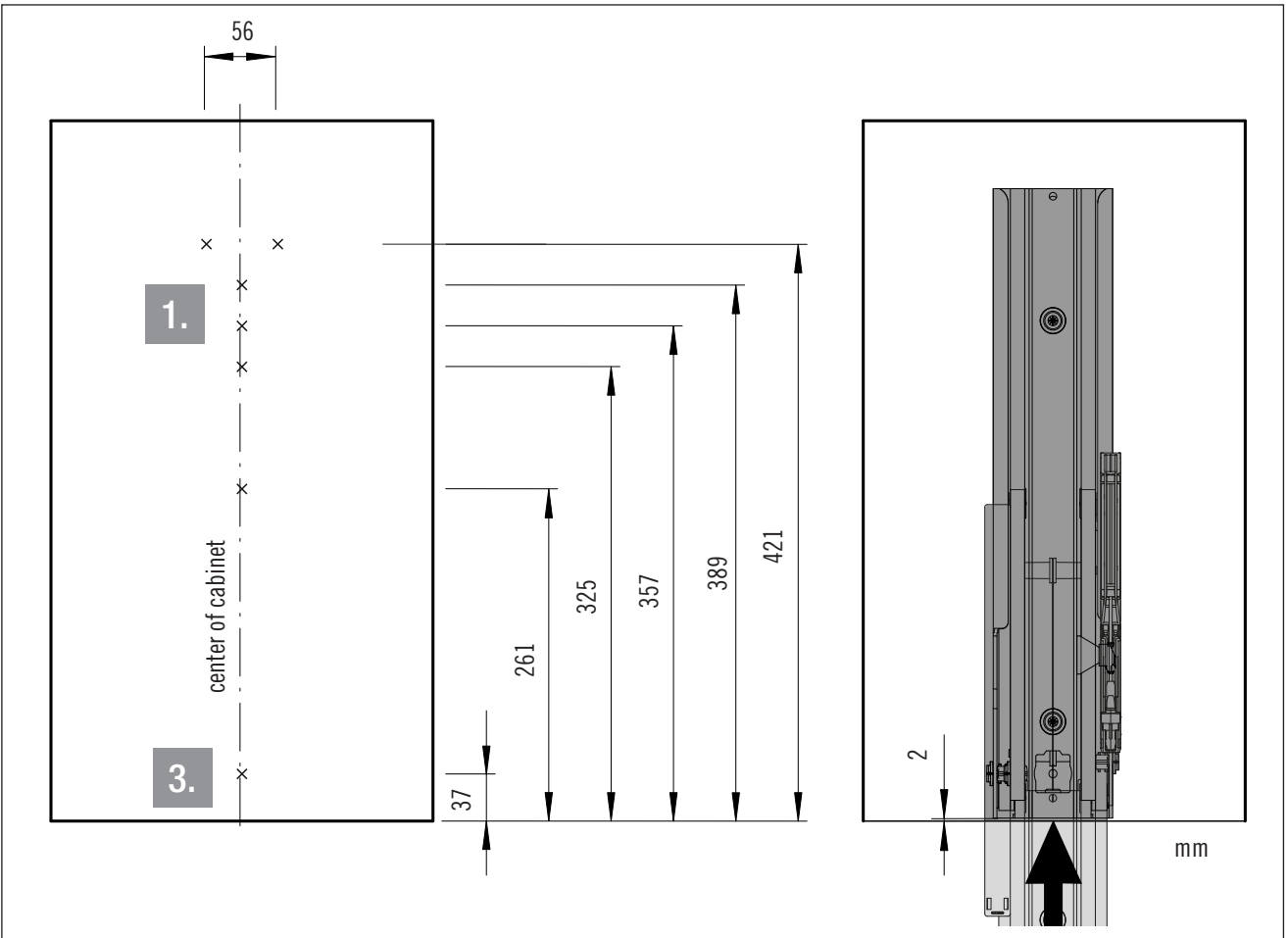
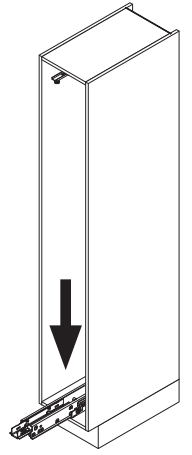
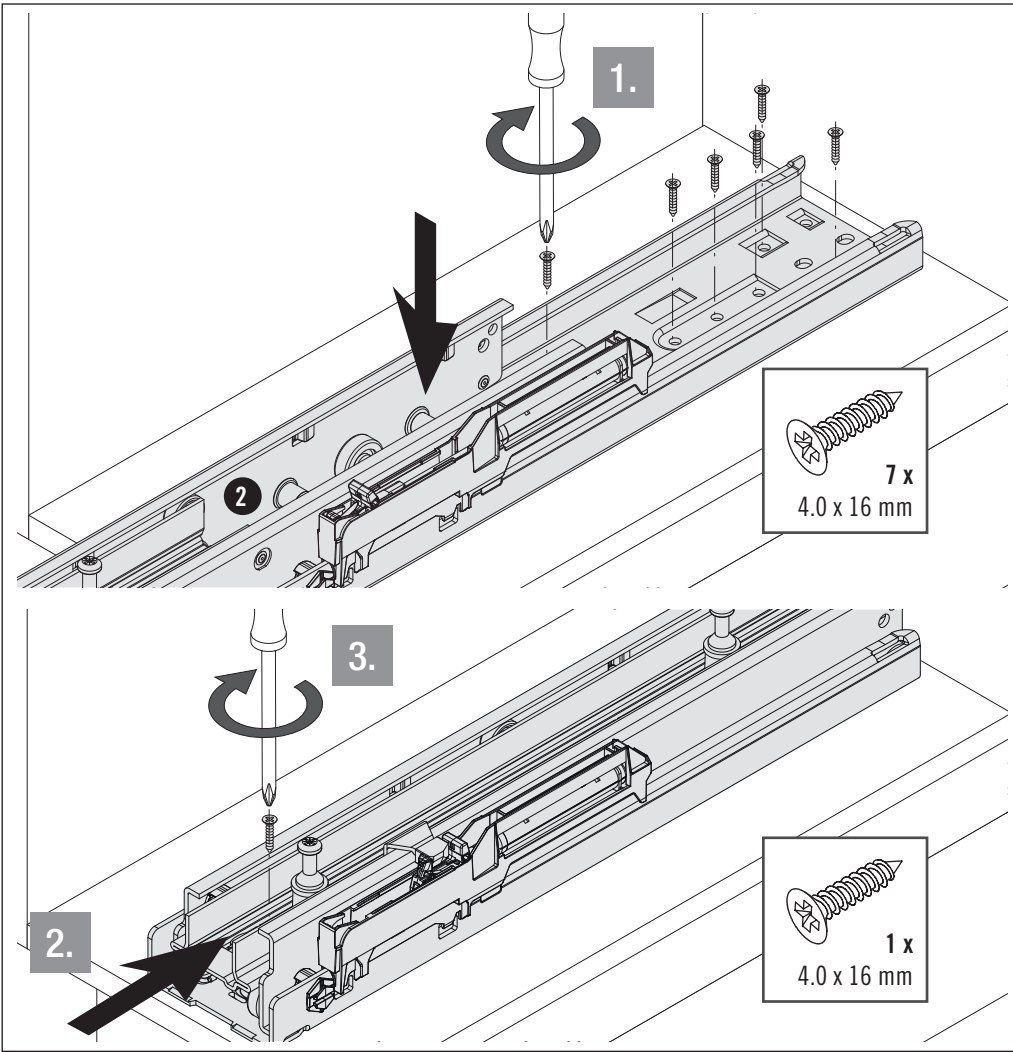

**3**

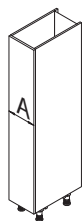
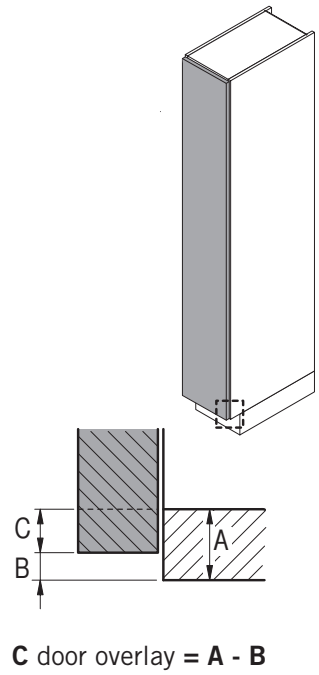
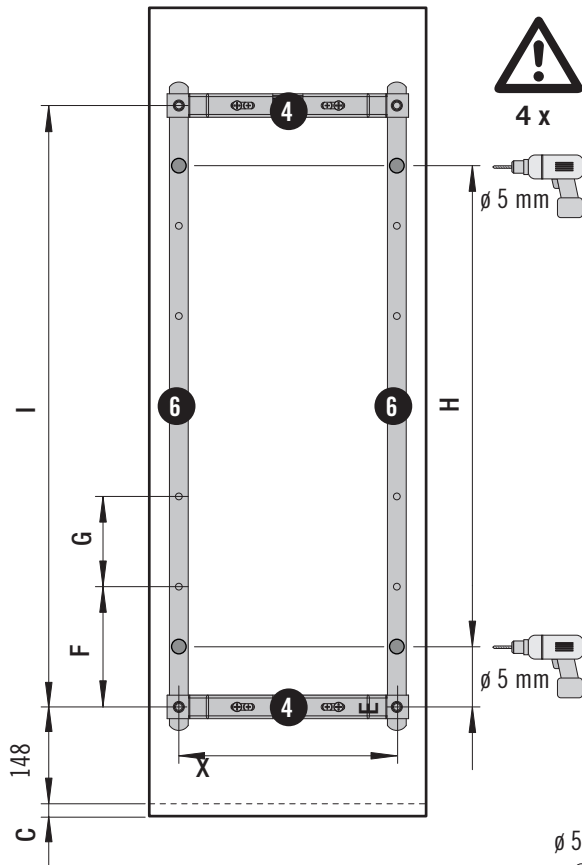
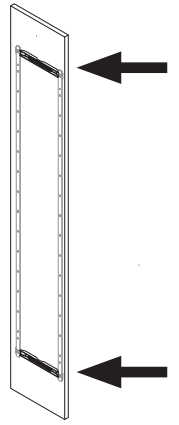
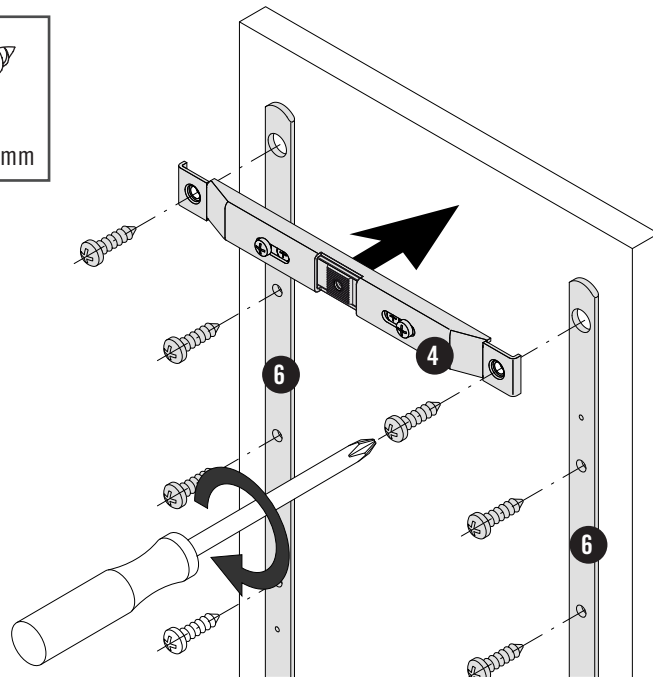
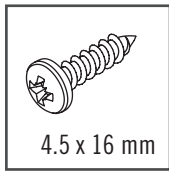

A	X
300	232
400	325
450	375
500	425
600	525

mm

VS TAL® Larder	E	F	G	H	I
1	64	96	2 x 96	256	384
2	64	128	4 x 96	512	640
3	64	112	7 x 96	768	896
4	64	96	10 x 96	1024	1152
5	64	128	12 x 96	1280	1408
6	64	96	14 x 96	1408	1536
7	64	96	16 x 96	1600	1728

mm

# 4

## Adjust the height of the frame!

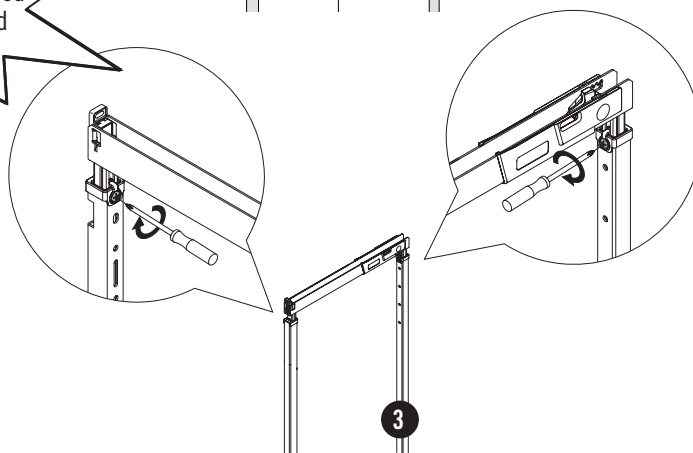
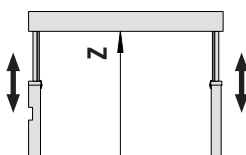
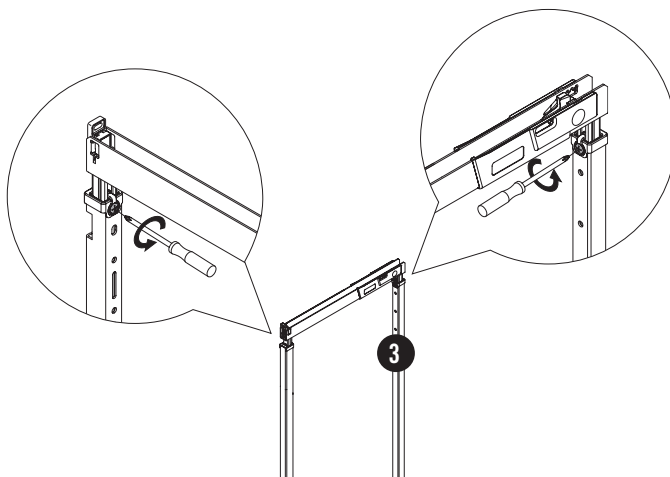
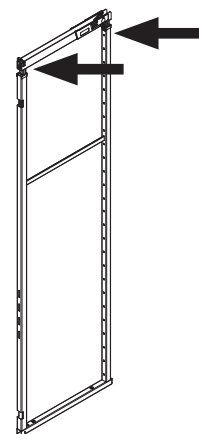
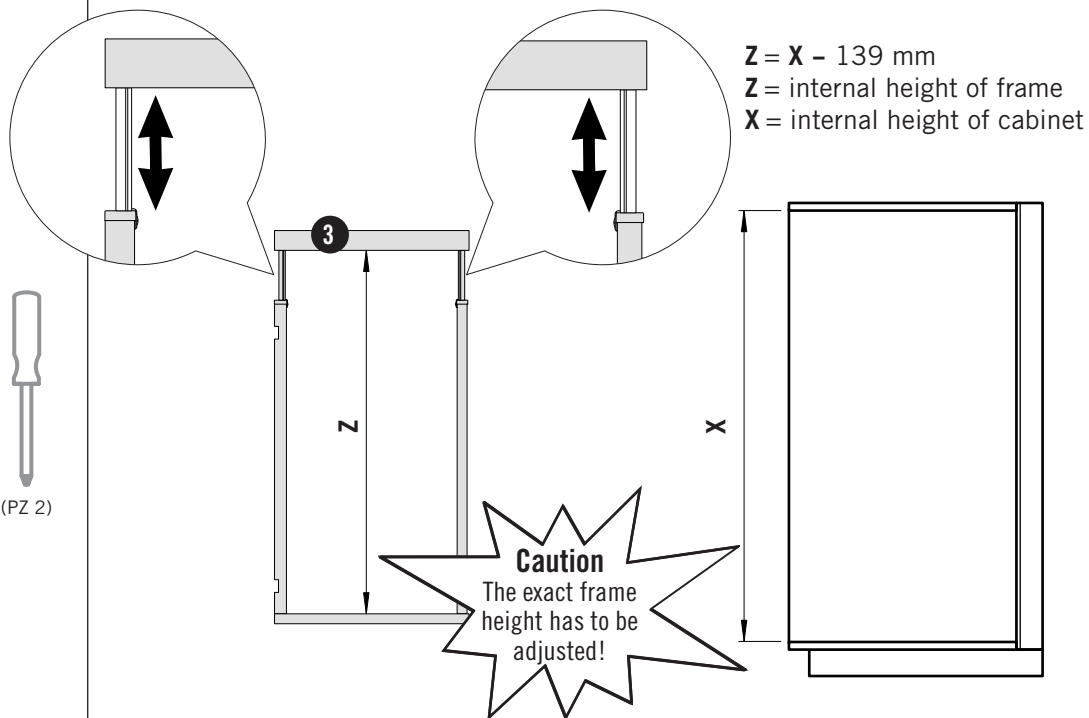

**5**



(PZ 2)

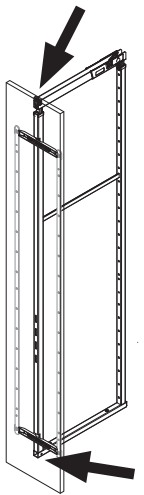
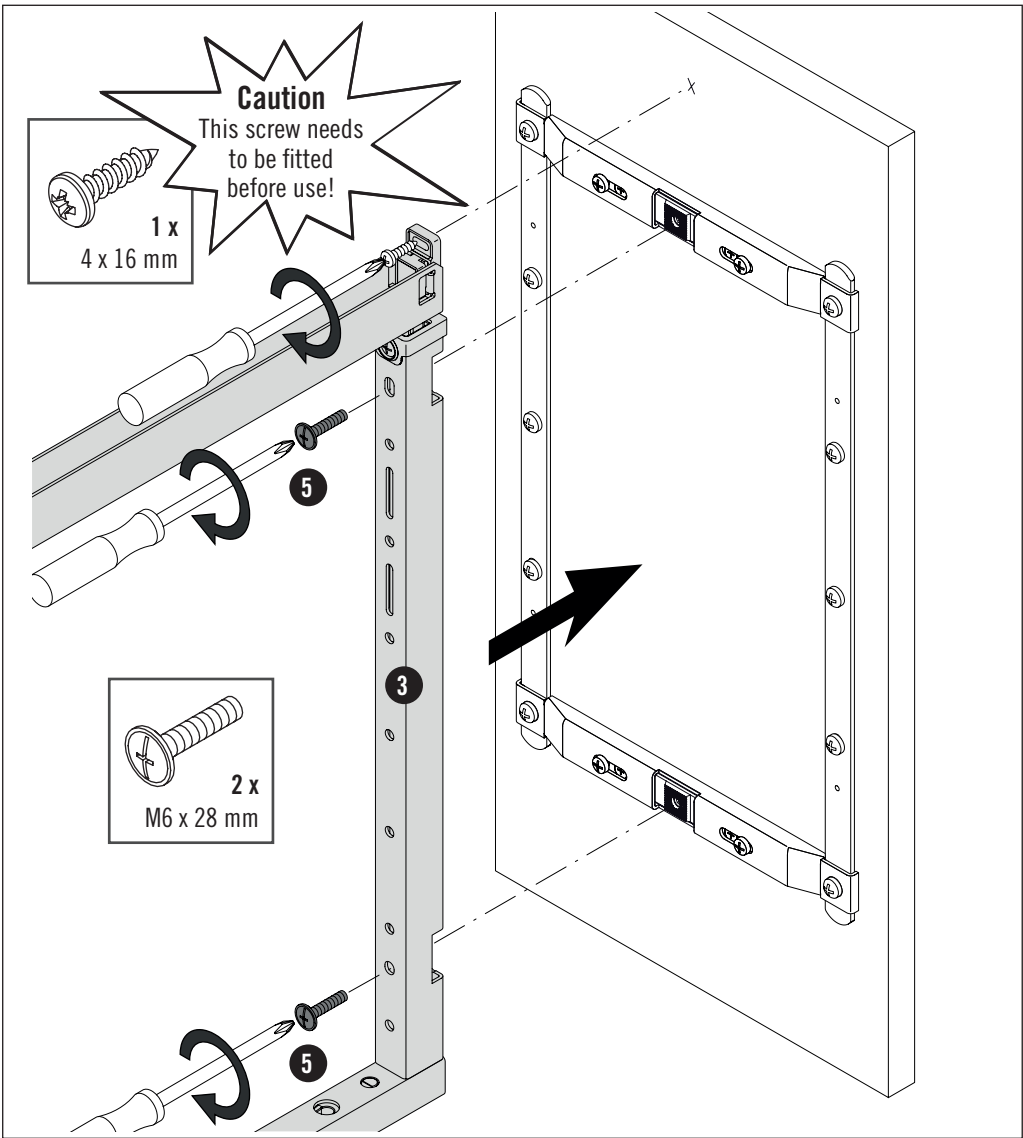

**6**

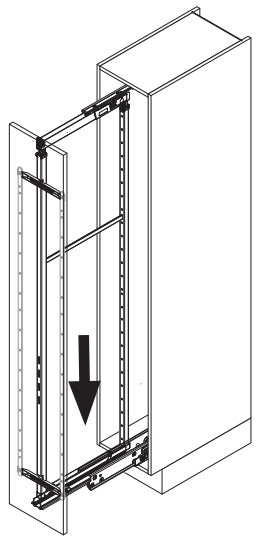
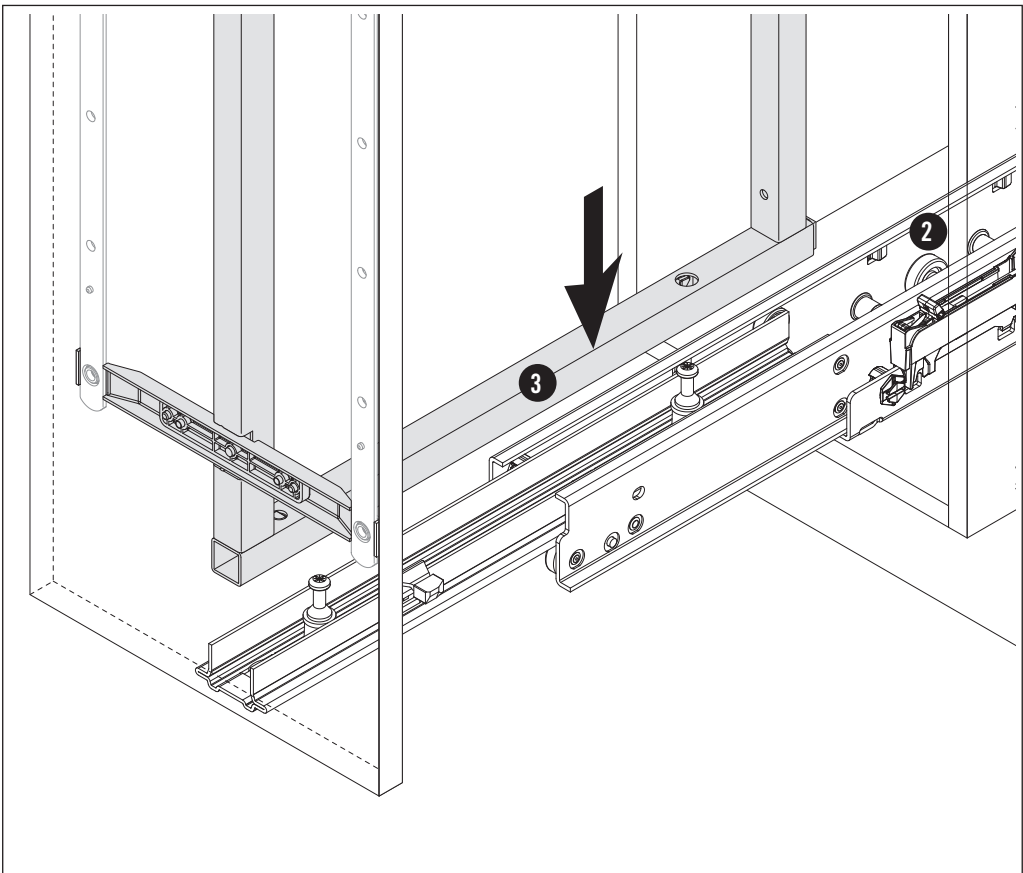

7

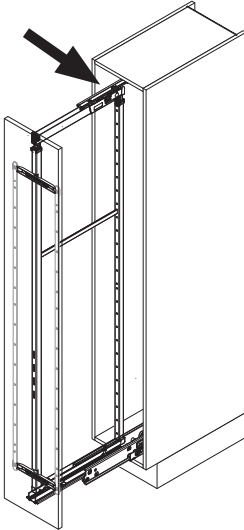
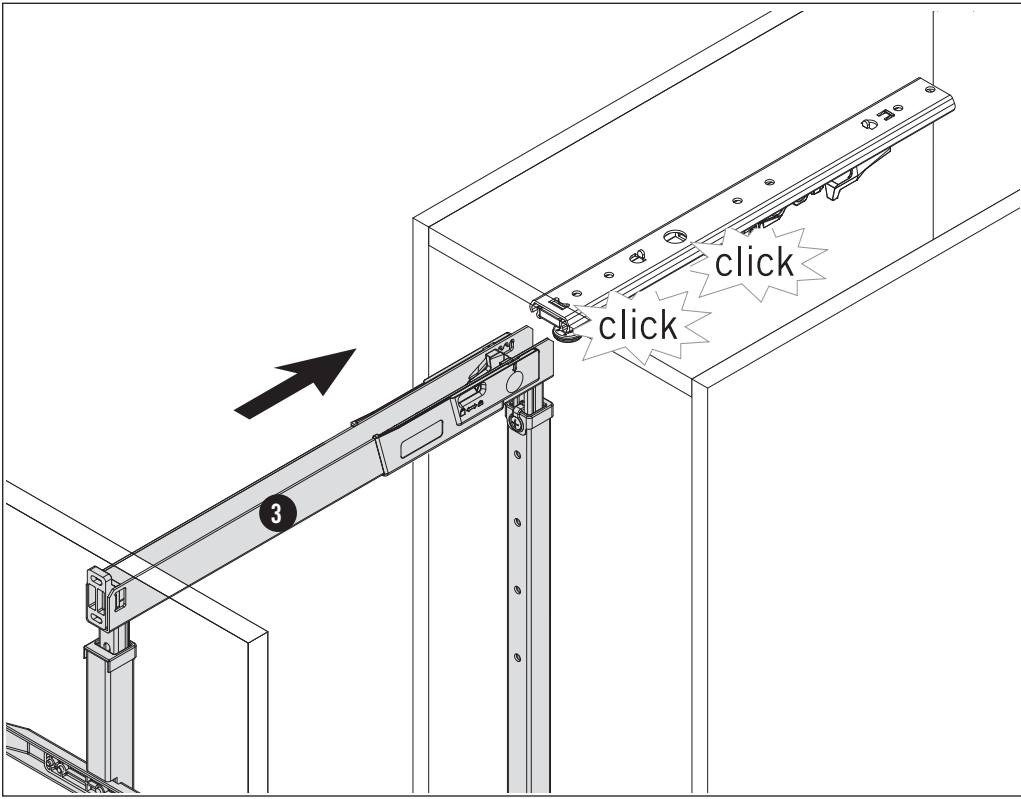

8



(PZ 2)

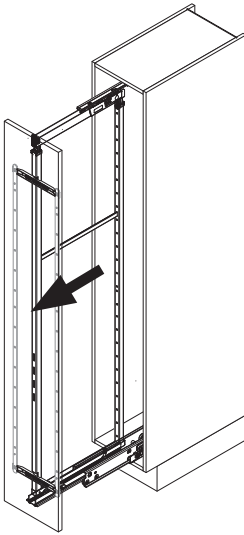
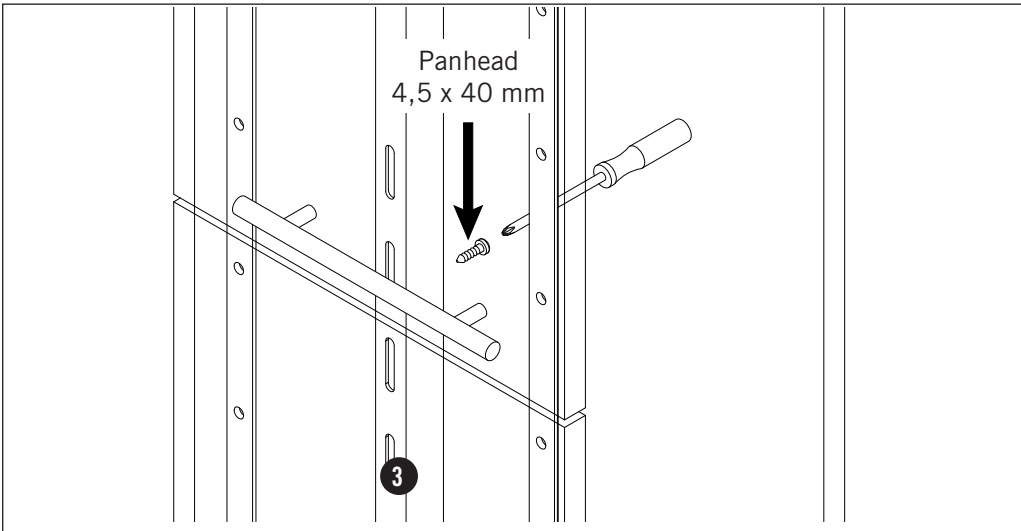

9

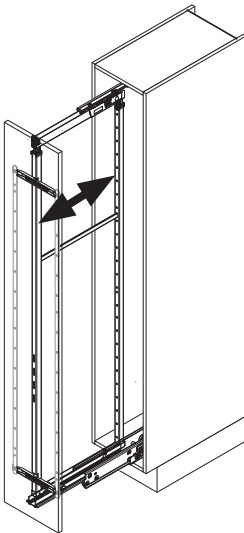
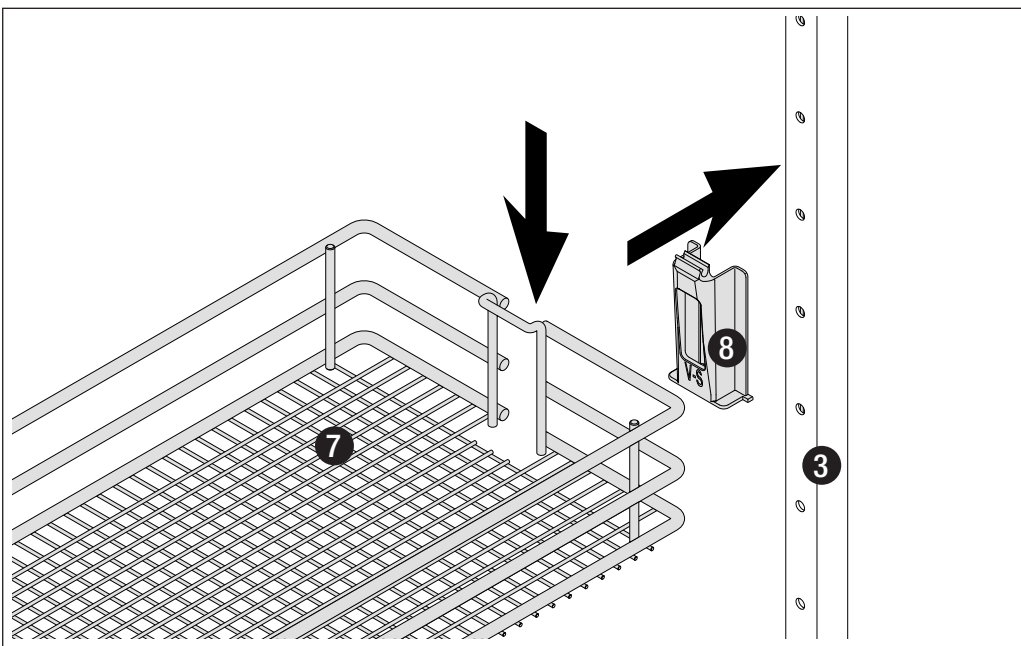





**A**



(PZ 2)

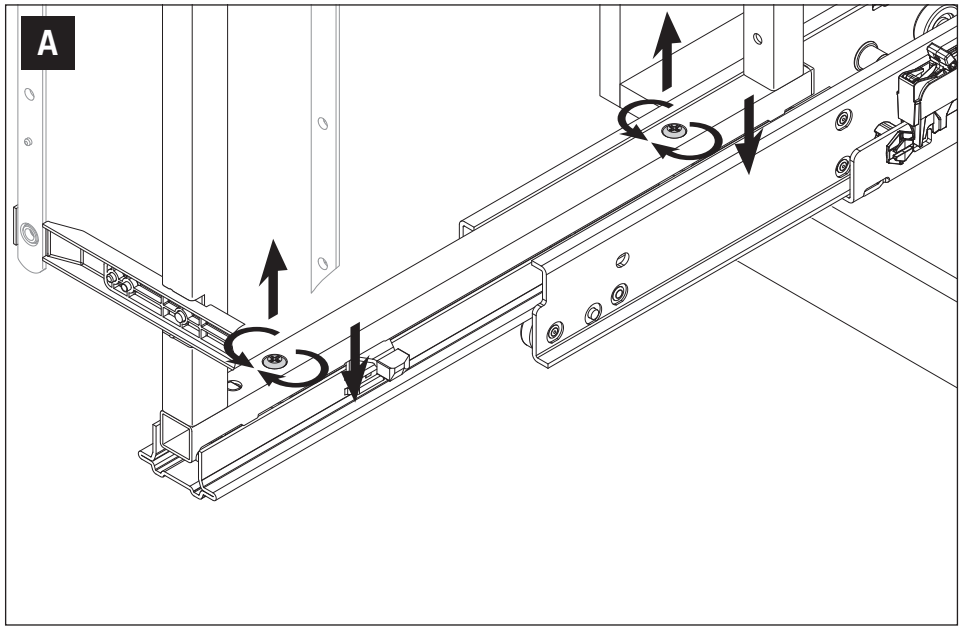
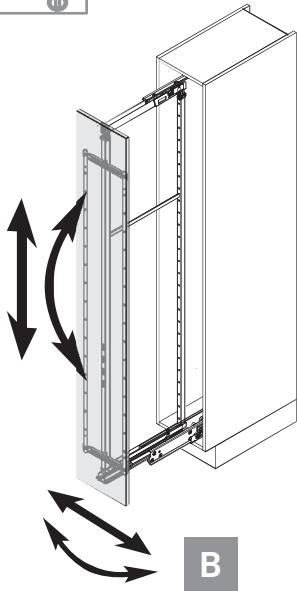

**B**



(PZ 2)

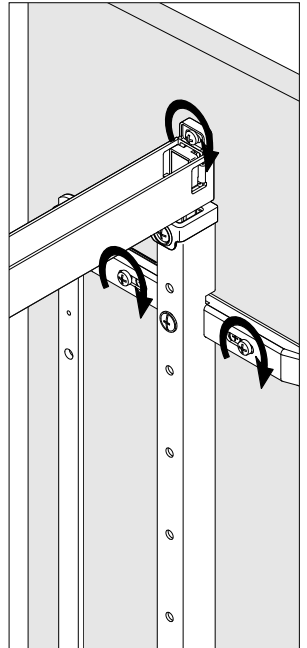
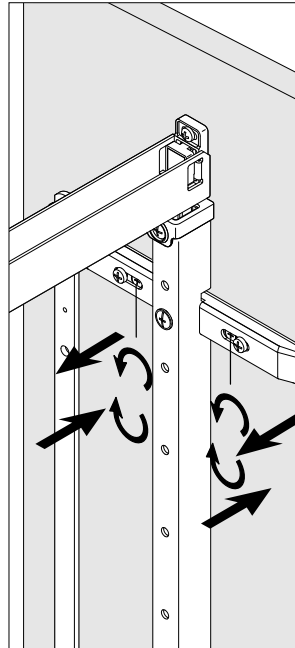
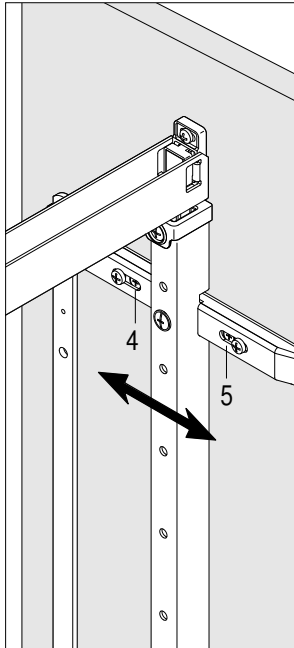
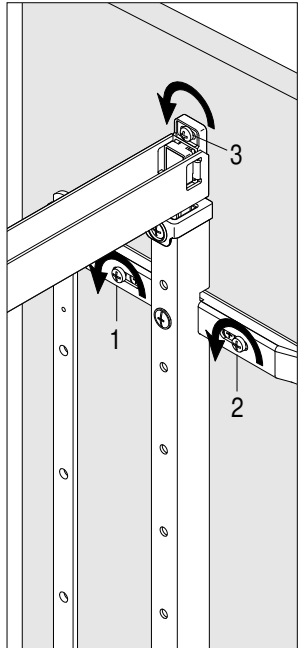

4 mm

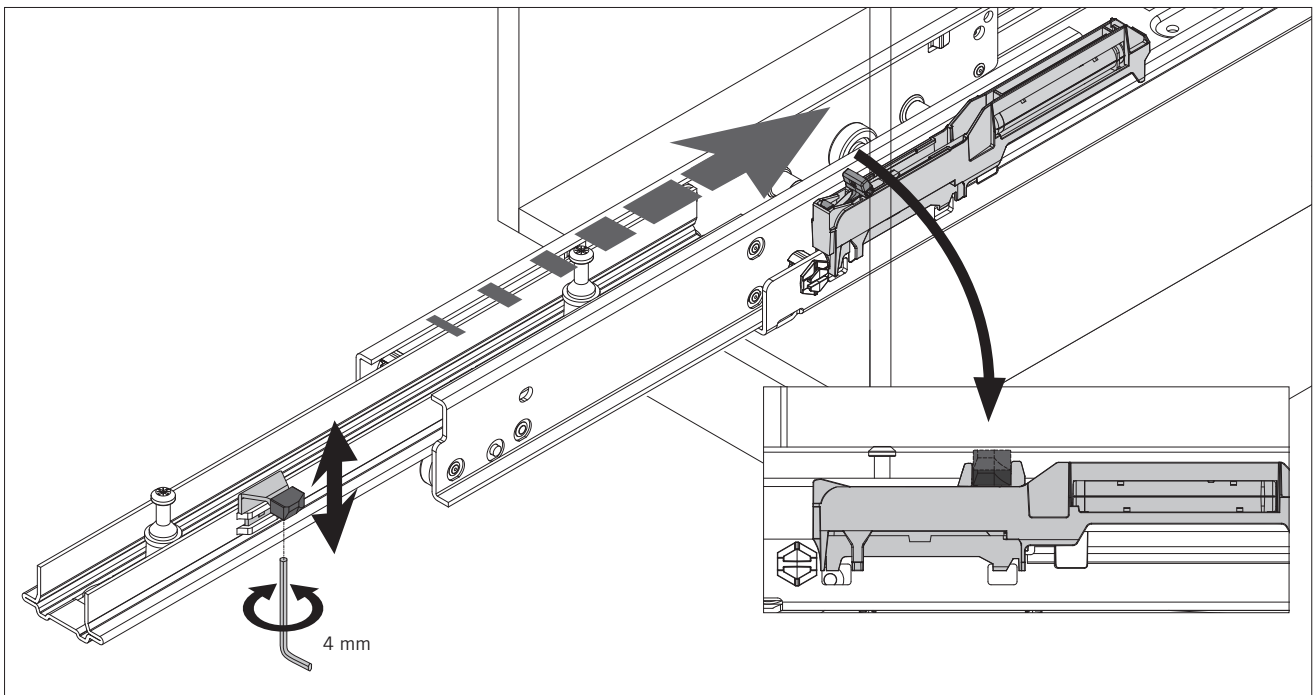

## Removal of the frame

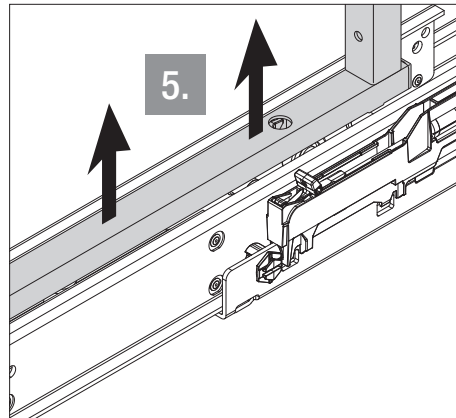
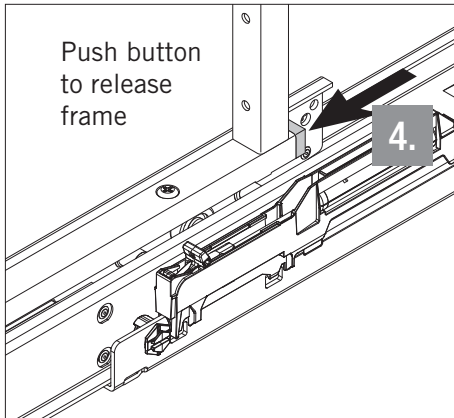
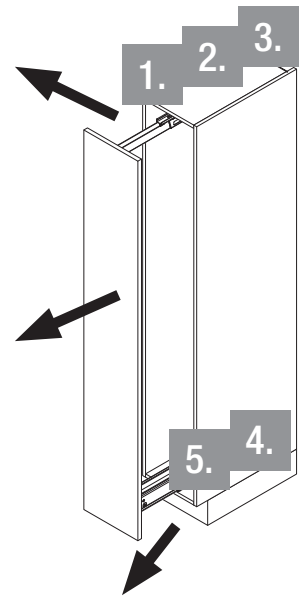
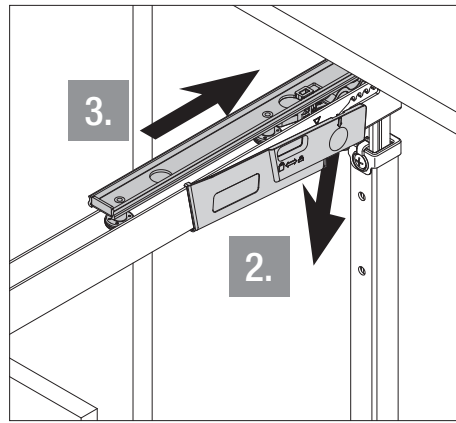
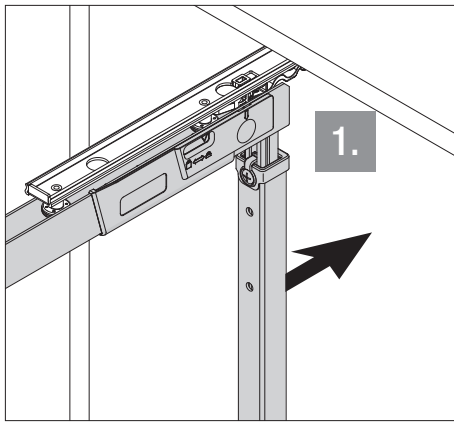

For reassembly follow from step 9

## Weight adjustment on frame

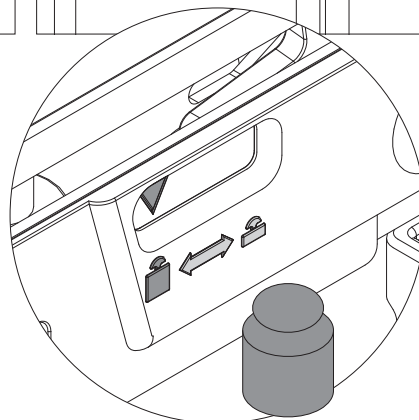
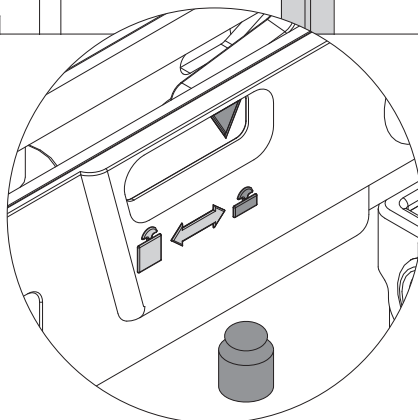
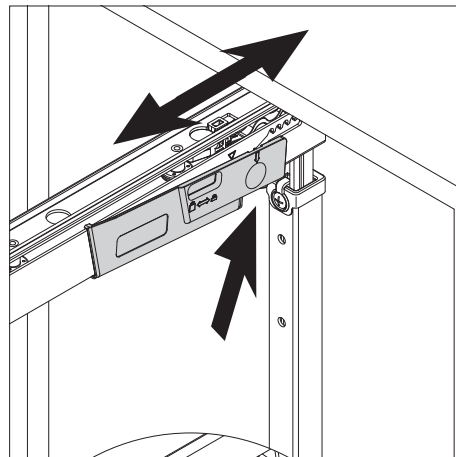
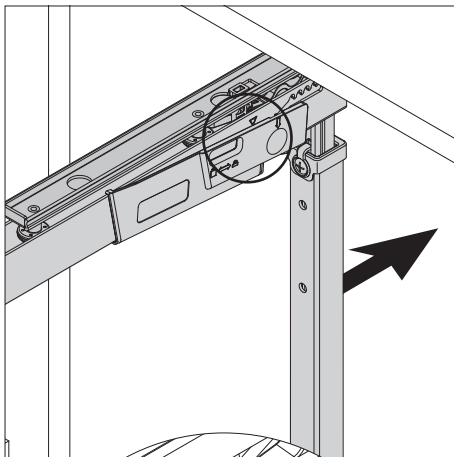

# BEFORE USE OF THIS LARDER UNIT PLEASE ENSURE THE FOLLOWING IMPORTANT SAFETY POINTS HAVE BEEN FOLLOWED.

On 400, 500 and 600 mm Width Versions ensure the 5<sup>th</sup> Plinth foot (included) has been fitted to the base in a central position (Page 2/12)

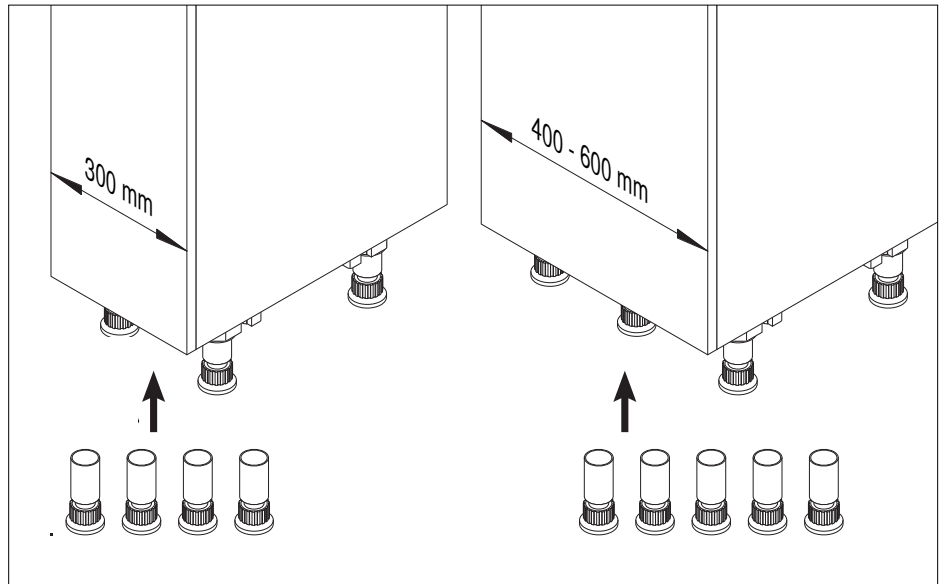

The frame has been correctly height adjusted to 139 mm less than the internal carcass height (Page 6/12)

**4**

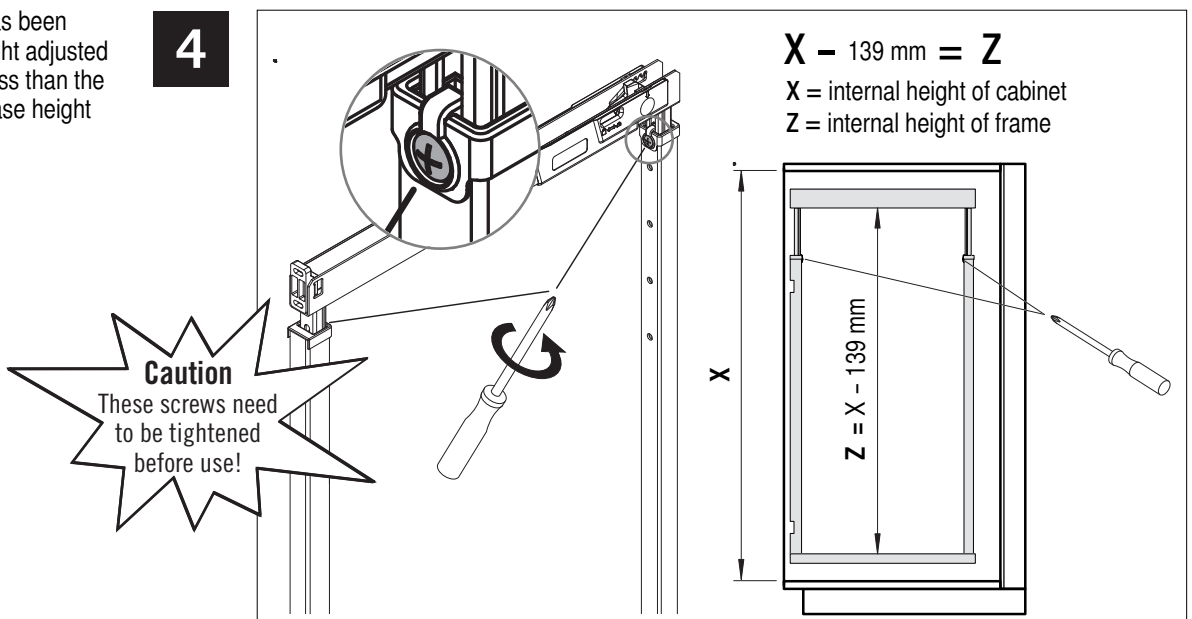

The security screw has been fitted through the top of the frame into the back of the top of the door (Page 6/12)

**5**

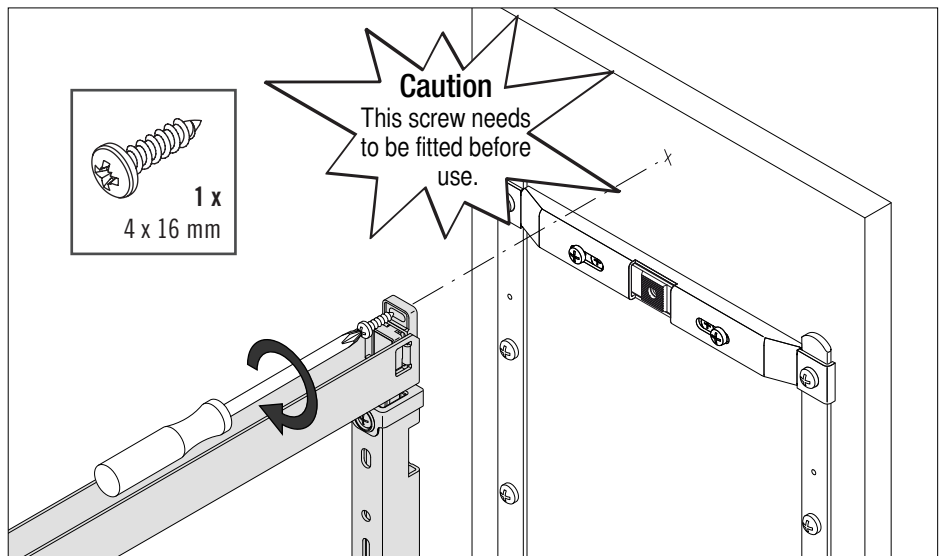

# BEFORE USE OF THIS LARDER UNIT PLEASE ENSURE THE FOLLOWING IMPORTANT SAFETY POINTS HAVE BEEN FOLLOWED.

The bottom runner is clear of dirt and debris - Please do not use any lubricants (Page 7/12)

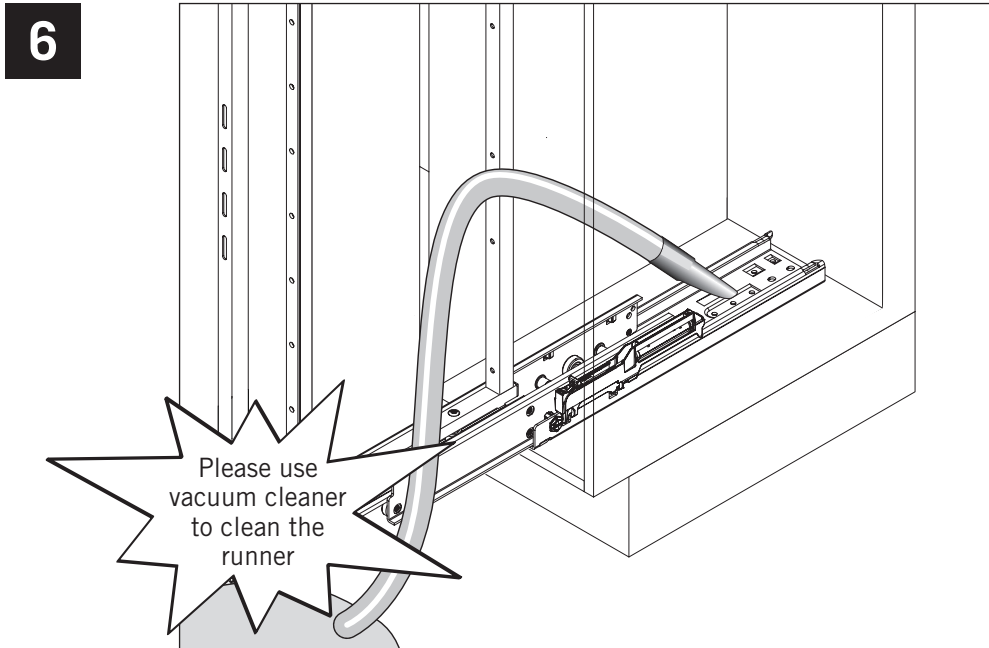

## Cleaning the lower runner

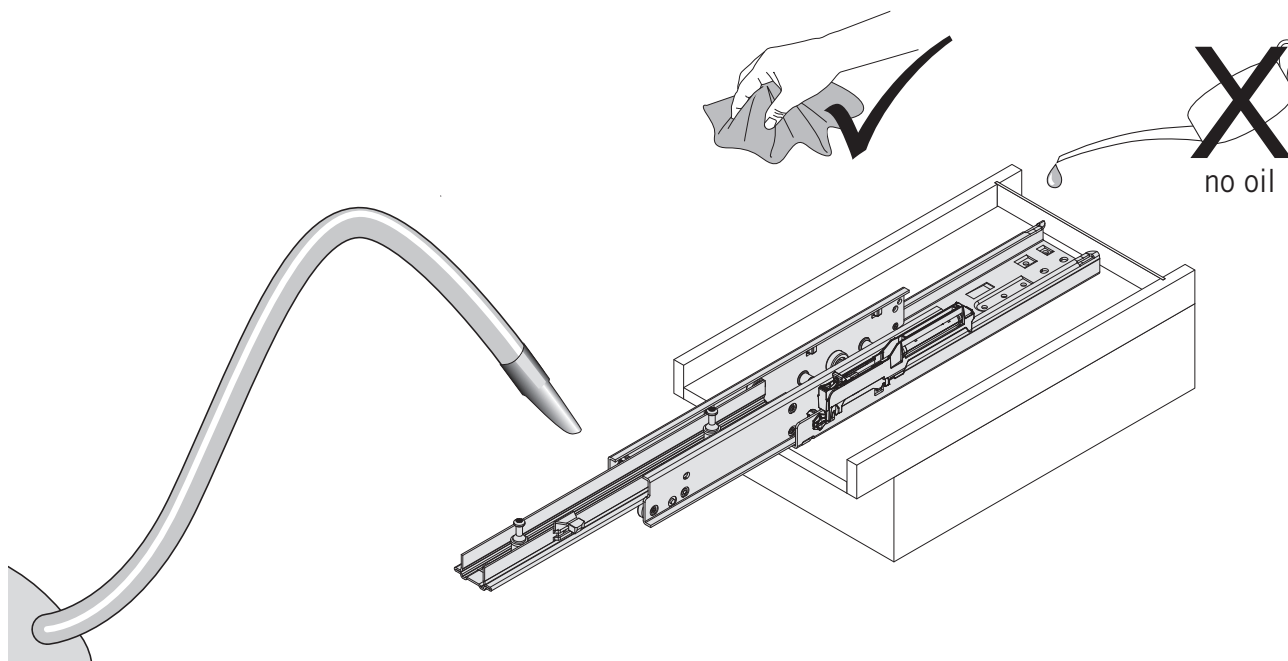

clean with dry cloth and vacuum cleaner only